

The Supra CT clamp incorporates a bespoke bolt and a series of conical washers to the already outstanding Supra clamp. This specialized version of the Supra clamp is used in applications subject to vibration and/or great variations in temperature which can cause the spring washer system, the Supra CT maintains constant pressure around the hose despite variations in temperature or vibration.

This clamp is generally fitted in combustion engines in construction machinery, trucks, tractors, buses, marine engines, military vehicles and diesel-powered generators. The bevelled edges protect the hose from damage.

The Supra CT clamp complies fully with the Directive EU 20032/95/EC.

MATERIAL: Band and bridge: W2
Stainless steel X6Cr 17
DIN 1.4016 AISI 430
Bolt: Stainless steel
AISI 430
Washers: Stainless steel
AISI 304

RESISTENCIA A LA CORROSIÓN: 72 hours salt spray
ASTM B-117

* The maximum application pressure can vary depending on the type of hose used and the geometry of the coupling.

Ø D ±2.0	Part Number	A	S ±0.03	G	R	L ±2.0	H	I	J ±0.3	K ±0.2	Box Quantity	Outer Box Quantity
17-19	03020100	18 +0.2-0	0,6	0.5-20	M6	50	3	1.8	17.0	9.0	50	50
19-21	03020118	18 +0.2-0	0,6	0.5-20	M6	50	3	1.8	17.0	9.0	50	50
21-23	03020126	18 +0.2-0	0,6	0.5-20	M6	50	3	1.8	17.0	9.0	50	50
23-25	03020134	18 +0.2-0	0,6	0.5-20	M6	50	3	1.8	17.0	9.0	50	50
25-27	03020142	18 +0.2-0	0,6	0.5-20	M6	50	3	1.8	17.0	9.0	50	400
27-29	03020150	18 +0.2-0	0,6	0.5-20	M6	50	3	1.8	17.0	9.0	50	50
29-31	03020169	20 +0.3-0	0,8	0.5-20	M7	70	4	2.4	18.0	10.0	50	50
31-34	03020177	20 +0.3-0	0,8	0.5-20	M7	70	4	2.4	18.0	10.0	50	50
34-37	03020185	20 +0.3-0	0,8	0.5-20	M7	70	4	2.4	18.0	10.0	50	50
37-40	03020193	20 +0.3-0	0,8	0.5-20	M7	70	4	2.4	18.0	10.0	50	50
40-43	03020206	20 +0.3-0	0,8	0.5-20	M7	80	4	2.4	18.0	10.0	50	50
43-47	03020214	20 +0.3-0	0,9	0.5-20	M7	80	4	2.4	18.0	10.0	50	50
47-51	03020222	20 +0.3-0	0,9	0.5-20	M7	80	4	2.4	18.0	10.0	50	50
51-55	03020230	20 +0.3-0	0,9	0.5-20	M7	80	4	2.4	18.0	10.0	25	25
55-59	03020249	20 +0.3-0	0,9	0.5-20	M7	80	4	2.4	18.0	10.0	25	25
59-63	03020257	20 +0.3-0	0,9	0.5-20	M7	80	4	2.4	18.0	10.0	25	25

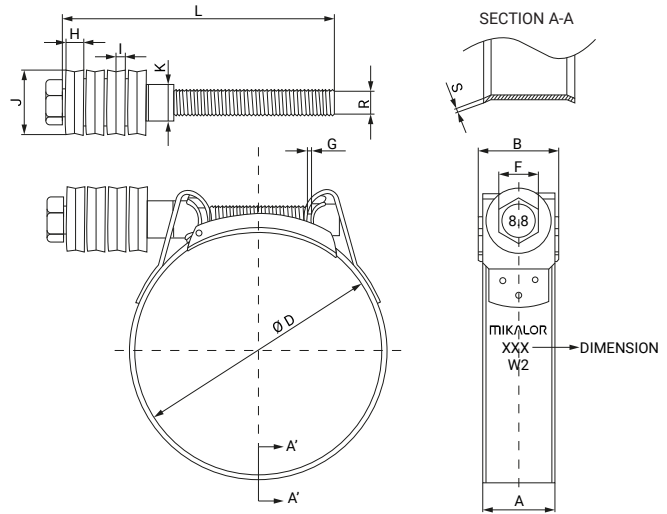

Ø D ±2.0	Part Number	A	S ±0.03	G	R	L ±2.0	H	I	J ±0.3	K ±0.2	Box Quantity	Outer Box Quantity
63-68	03020265	20 +0.3-0	0,9	0.5-20	M7	80	4	2.4	18.0	10.0	25	25
68-73	03020273	25 +0.4-0	1.0	0.5-20	M8	110	8	2.0	20.0	12.0	25	25
73-79	03020281	25 +0.4-0	1.0	0.5-20	M8	110	8	2.0	20.0	12.0	25	25
79-85	03020290	25 +0.4-0	1.0	0.5-20	M8	110	8	2.0	20.0	12.0	25	25
85-91	03020302	25 +0.4-0	1.0	0.5-20	M8	110	8	2.0	20.0	12.0	25	25
91-97	03020310	25 +0.4-0	1.0	0.5-20	M8	110	8	2.0	20.0	12.0	25	25
97-104	03020329	25 +0.4-0	1.0	0.5-20	M8	130	10	2.0	20.0	12.0	25	25
104-112	03020337	25 +0.4-0	1.0	0.5-20	M8	130	10	2.0	20.0	12.0	25	25
112-121	03020345	25 +0.4-0	1.0	0.5-20	M8	130	10	2.0	20.0	12.0	25	25
121-130	03020353	25 +0.4-0	1.0	0.5-20	M8	130	10	2.0	20.0	12.0	25	25
130-140	03020361	28 +0.4-0	1.2	0.5-20	M10	175	10	3.1	20.5	14.0	10	10
140-150	03020370	28 +0.4-0	1.2	0.5-20	M10	175	10	3.1	20.5	14.0	10	10
150-162	03020388	28 +0.4-0	1.2	0.5-20	M10	175	10	3.1	20.5	14.0	10	10
162-174	03020396	28 +0.4-0	1.2	0.5-20	M10	175	10	3.1	20.5	14.0	10	10
174-187	03020409	28 +0.4-0	1.2	0.5-20	M10	175	10	3.1	20.5	14.0	10	10
187-200	03020417	28 +0.4-0	1.2	0.5-20	M10	175	10	3.1	20.5	14.0	10	10
200-213	03020425	28 +0.4-0	1.2	0.5-20	M10	175	10	3.1	20.5	14.0	10	10
213-226	03020433	28 +0.4-0	1.2	0.5-20	M10	175	10	3.1	20.5	14.0	10	10
226-239	03020441	28 +0.4-0	1.2	0.5-20	M10	175	10	3.1	20.5	14.0	10	10
239-252	03020450	28 +0.4-0	1.2	0.5-20	M10	175	10	3.1	20.5	14.0	10	10