

DIN 5299 snap hook with safety latch

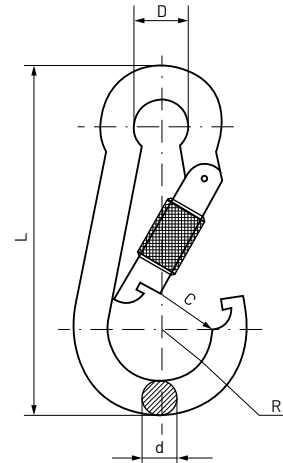
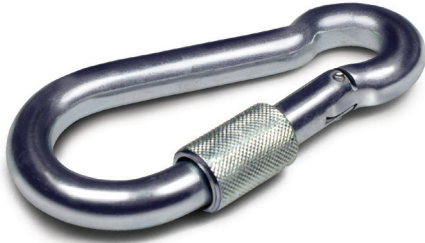

The DIN 5299 with a safety latch offers the advantage that the safety latch between the hinge and the body of the DIN 5299 hinders it being opened due to carelessness, friction or error.

The inner thread of the safety latch ensures maximum grip and the outer grooves of the latch facilitates manual threading.

TIPS: In order not to compromise safety, the SWL established for each size must never be exceeded. The quality of the finish guarantees a very good corrosion resistance. Industrial use, wire and chain attachment (No PPE).

MATERIAL: Steel C15
FINISH: Zinc plated

Size d x L	Denomination	Part Number	L	d	D	C	2R	Workload W.L.L (kg)	Box Quantity	Outer Box Qty.
4 x 40	DIN 5299 D104	09552799	40	4	7	7	14	70	200	2000
5 x 50	DIN 5299 D105	09552868	50	5	8	7	15,5	100	100	600
6 x 60	DIN 5299 D106	09552806	60	6	9	8	18	120	100	600
7 x 70	DIN 5299 D107	09552814	70	7	10	8	20	180	100	400
8 x 80	DIN 5299 D108	09552822	80	8	12	9	24	230	50	300
9 x 90	DIN 5299 D109	09552902	90	9	12	10	25	250	25	200
10 x 100	DIN 5299 D110	09552830	100	10	15	11	30	350	25	150
11 x 120	DIN 5299 D111	09552849	120	11	18	16	36	400	25	100
12 x 140	DIN 5299 D112	09552857	140	12	20	19	40	450	10	60

These products are not PPE (Personal Protection Equipment)